



# Hydraulic Presses

## Standard and Custom Solutions



Enerpac Hydraulic Presses are available in a variety of capacities and sizes. The press frames are designed for maximum strength and durability. Strong frames and powerful high-pressure hydraulics will provide years of dependable service in many applications.

Enerpac Presses are available in Bench presses, C-frame, Arbor, Workshop and Roll-Frame models.

## Safety

When working with High pressure hydraulics always use Personal protection equipment.



## Safety options

To protect people against hazard of unexpected incidents during operation, we offer safety cages and frames. Made of high impact resistant polycarbonate glass in an aluminum frame it provides maximum safety and visibility. In combination with electric driven hydraulic pumps we offer 2-hand operator stands and safety switches on access doors.







## Custom made presses

Next to an extensive line of standard presses, Enerpac offers, as market leader in high pressure hydraulics, also the possibility for customization. Whether a longer stroke, wider frame or complete new design is required, our special product group has many years of experience in all kind of industries.



# Hydraulic Presses Section Overview

## ▼ INDEX

| Presses                          |  |          |  |                |
|----------------------------------|--|----------|--|----------------|
| Capacity ton (kN)                | Press Type   | Series   |  | Page           |
| <b>10</b><br>(101)               | A-Series, C-Clamp and Arbor Presses<br>VLP-Series, Bench Presses | A, VLP   |   | <b>4 - 5</b>   |
| <b>25 - 75</b><br>(232 - 718)    | XLP-Series, Workshop Presses                                     | XLP      |   | <b>6 - 7</b>   |
| <b>100 - 200</b><br>(989 - 1995) | VLP-Series, Workshop Presses                                     | VLP      |   | <b>8 - 9</b>   |
| <b>50 - 200</b><br>(498 - 1995)  | BPR-Series, Roll-Frame Presses                                   | BPR      |   | <b>10 - 11</b> |
| <b>25 - 200</b><br>(232 - 1995)  | Press Safety Options and Accessoires                             | VLP, XLP |   | <b>12 - 15</b> |
| <b>10 - 200</b><br>(101 - 1995)  | Special Presses  |          |  | <b>16 - 23</b> |



### IMPORTANT!

**The frameworks of the workshop presses are exclusively designed for pressing operations, not for pulling. For pulling applications please contact Enerpac.**

In order to fully comply with CE regulations, some presses must be equipped with specific safety components, such as spring centered valves, two-hand control devices, guards or others.

Enerpac standard general purpose presses are supplied without guards, and have a plunger speed of less than 10 mm/second. However, your application may require that measures should be taken to reduce the risk of injury to operators and other personnel by providing appropriate safeguarding, training and conducting a risk assessment, which eliminates or reduces danger.

Health & safety within your workplace is your responsibility, not that of Enerpac.

Advice on such matters is available from your local enforcement agency. If you require any further information on Enerpac accessories that may help you conform to the Machinery Directive or European legislation contact Enerpac.



▼ A-220, A-330 AND A-310



## The Standard Workshop Tools

▼ VLP-106P142



- **C-Clamp Press:**  
Operational in all positions
- **Arbor Press:**  
Foot mounting holes for horizontal or vertical positioning
- **Bench Mounted Press:**  
10 Ton press frame including hand or air operated hydraulic pump.

▼ A-205, A-210, A-220

▼ A-310, A-330

▼ VLP106

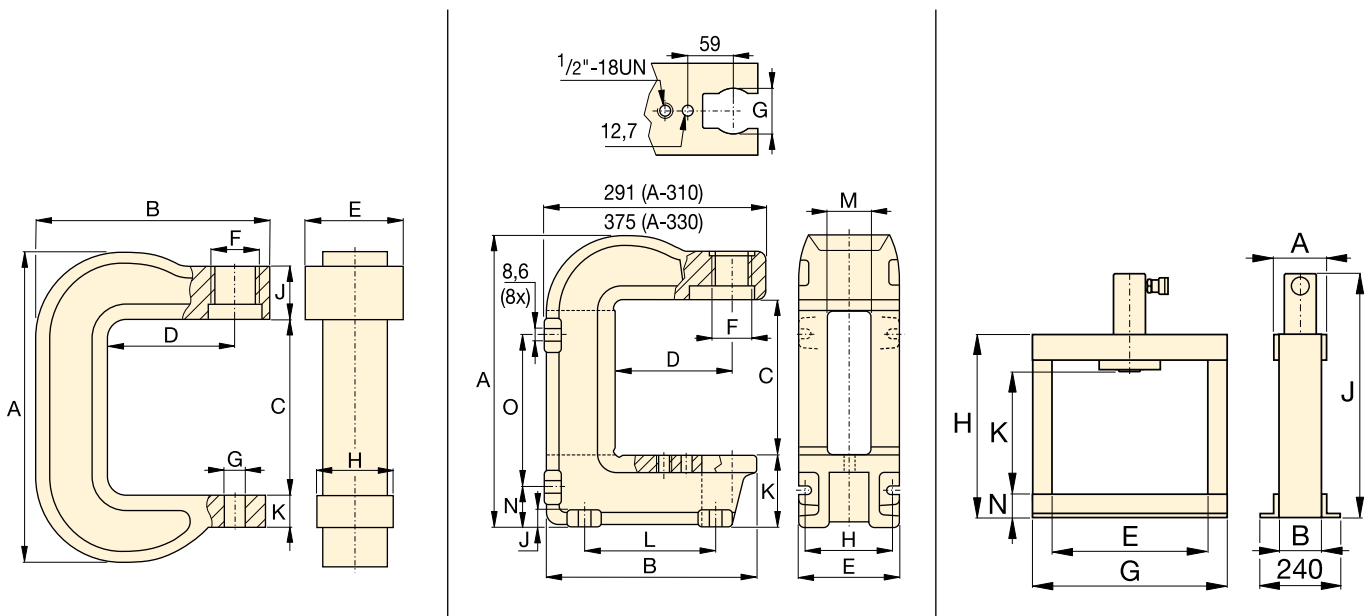

# C-Clamp and Bench Presses

## ▼ A-SERIES AND VLP-SERIES PRESS DIMENSIONS CHART

| Press Series               | C-Clamp*      |               |                  | Arbor*        |                  | Bench       |             |
|----------------------------|---------------|---------------|------------------|---------------|------------------|-------------|-------------|
| Capacity ton (kN)          | 5 (45)        | 10 (101)      | 20 (178)         | 10 (101)      | 30 (295)         | 10 (101)    |             |
| Model Number               | A-205         | A-210         | A-220            | A-310         | A-330            | -           | -           |
| Hand pump                  | -             | -             | -                | -             | -                | VLP-106P142 | -           |
| Air pump                   | -             | -             | -                | -             | -                | -           | VLP-106PAT1 |
| Cylinder Type (RC-Series)* | 5 ton         | 10 ton        | 25 ton**         | 10 ton        | RC-308           | -           | -           |
| Cylinder Stroke (mm)       | -             | -             | -                | -             | -                | 156         | 156         |
| Vertical Daylight, Min.    | 165           | 228           | 305              | 227           | 260              | 430         | 430         |
| Horizontal Daylight, Max.  | -             | -             | -                | -             | -                | 435         | 435         |
| Bed Width.                 | 51            | 57            | 70               | 135           | 178              | 240         | 240         |
| A                          | 291           | 406           | 540              | 414           | 557              | 110         | 110         |
| B                          | 203           | 283           | 346              | 281           | 353              | 80          | 80          |
| C                          | 165           | 228           | 305              | 230           | 260              | -           | -           |
| D                          | 95            | 152           | 152              | 152           | 152              | -           | -           |
| E                          | -             | -             | -                | -             | -                | 435         | 435         |
| F                          | 1 1/2"-16 uns | 2 1/4"-14 uns | 3 5/16" - 12 uns | 2 1/4"-14 uns | 3 5/16" - 12 uns | -           | -           |
| G                          | 26            | 26            | 26               | 63            | 63               | 542         | 542         |
| H                          | 51            | 76            | 95               | 122           | 140              | 620         | 620         |
| J                          | 66            | 64            | 70               | 19            | 25               | 748         | 748         |
| K                          | 25            | 41            | 44               | 97            | 165              | 430         | 430         |
| L                          | -             | -             | -                | 175           | 203              | -           | -           |
| M                          | -             | -             | -                | 65            | 67               | -           | -           |
| N                          | -             | -             | -                | 54            | 98               | 80          | 80          |
| O                          | -             | -             | -                | 219           | 276              | -           | -           |
| Weight (kg)                | 7             | 17            | 38               | 27            | 86               | 49          | 54          |

\* Recommended cylinder must be ordered separately.

\*\* Must be limited to 20 ton.



### Hydraulic Pumps

Pumps for C-Clamps and Arbor Presses must be ordered separately.



### Optional V-Blocks, VB-10

To facilitate positioning of pipes and bars, or placed upside-down, to serve as a convenient worktable. Featuring precise fit into the press bolster. Each model number includes two V-blocks.

▼ XLP-75 - 25 TON



- Side-to-side cylinder movement
- Winch for easy height adjustment of press bed
- Open frame (XLP-50 and XLP-75)
- Electric pumps with remote valve operation.

## The Universal Workshop Tool



### Easy grip forklift access

Cut-away in lower frame for pallet truck access allows easy transportation of 50 and 75 ton XLP-series presses.



### Winch

Movable upper and lower bed with self-braking winch on XLP-Series presses.



### Press Kits \*

The 50 and 75 ton presses come standard as unassembled kits, and include complete press frame, winch, cylinder, pump with gauge, couplers and hose.

\* 50 and 75 ton XLP-Series presses can be ordered as factory assembled press frame. Add suffix "M" to press model number. Example: **XLP-506XA12G-M**.

▼ XLP-25

▼ XLP-50 -XLP-75

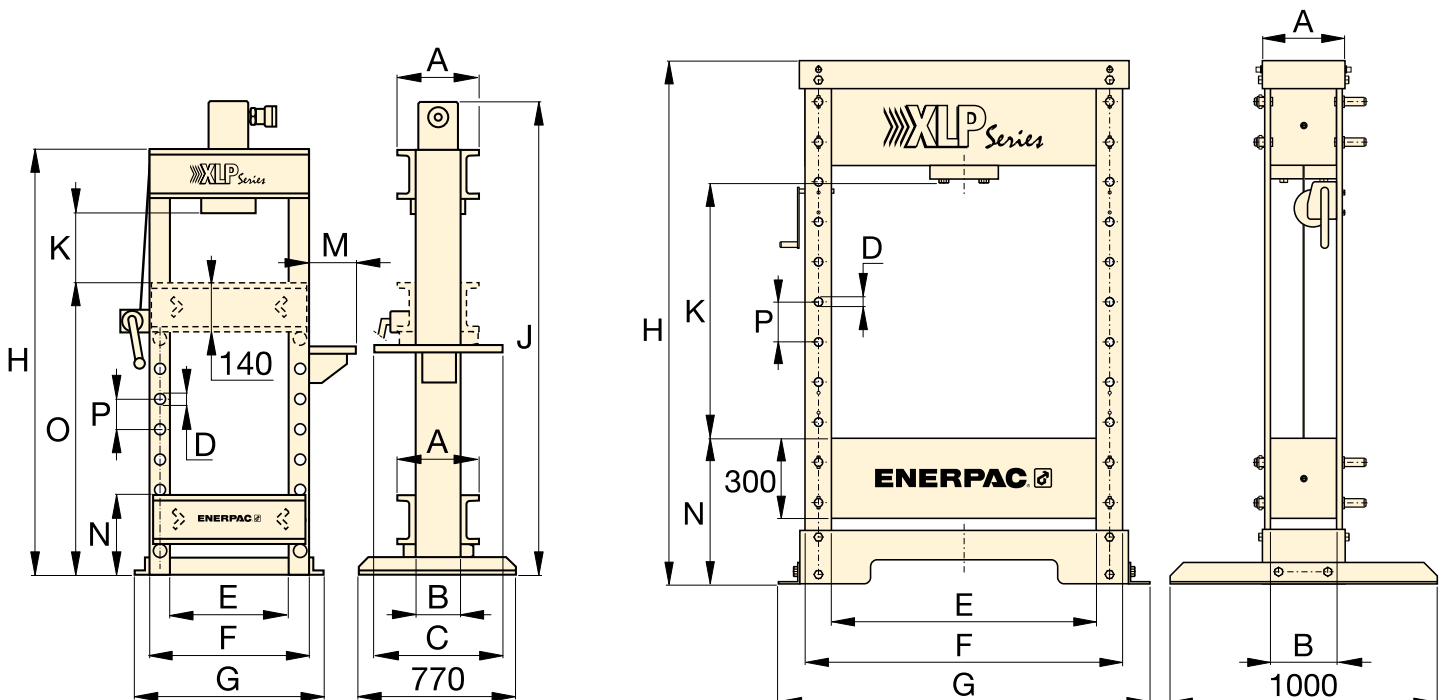



# XLP-Series, Hydraulic Workshop Presses

## ▼ PRESS DIMENSIONS CHART (IN MM)

| Press Series        | Cylinder Stroke | XLP-25          | XLP-50          | XLP-75          |
|---------------------|-----------------|-----------------|-----------------|-----------------|
| Capacity ton (kN)   |                 | <b>25</b> (232) | <b>50</b> (498) | <b>75</b> (718) |
| Hand pump           | 156             | XLP-256P392     | XLP-506P802     | -               |
| Air pump            | 156             | XLP-256XA11G    | XLP-506XA12G    | XLP-756XA12G    |
| Electric pump       | 156             | -               | XLP-506ZES      | -               |
|                     | 334             | -               | XLP-5013ZES     | -               |
| Vertical Daylight   | -               | 370 - 858       | 210 - 940       | 210 - 940       |
| Horizontal Daylight | -               | 510             | 990             | 990             |
| Bed Width           | -               | 140             | 240             | 330             |
| A                   | -               | 260             | 310             | 420             |
| B                   | -               | 140             | 240             | 330             |
| C                   | -               | 610             | -               | -               |
| D                   | -               | 32              | 32              | 40              |
| E                   | -               | 510             | 990             | 990             |
| F                   | -               | 630             | 1190            | 1240            |
| G                   | -               | 700             | 1390            | 1430            |
| H                   | -               | 1622            | 1995            | 1995            |
| J                   | -               | 1740            | -               | -               |
| K                   | -               | 370 - 858       | 210 - 940       | 210 - 940       |
| M                   | -               | 140 - 323       | -               | -               |
| N                   | -               | 210             | 540             | 540             |
| O                   | -               | 1070            | -               | -               |
| P                   | -               | 122             | 150             | 150             |
| Weight (kg)         | -               | 170             | 700             | 900             |



### Optional V-Blocks

To facilitate positioning of pipes and bars, or placed upside-down, to serve as a convenient worktable. Featuring precise fit into the press bolster. Each model number includes two V-blocks.

| To be used with press (ton) | V-Blocks (set) Model Number |
|-----------------------------|-----------------------------|
| 25                          | VB-25                       |
| 50                          | VB-501                      |
| 75                          | VB-101                      |

▼ VLP-100 OR 200



## VLP-Series Presses



### Hydrajust

Allowing effortless daylight adjustment by moving the lower bed up and down  
Can be used with presses equipped with double-acting cylinder.



### Electric Pumps

ZE-Series, 700 bar Electric Pumps with pendant operated valves provide maximum flexibility in operation of the press cylinder.

- Open frame
- Pump mounted gauge for optimal safety.
- Revolving pump table for optimal flexibility
- “Hydrajust” for lower bed positioning
- Electric pumps with remote valve operation

▼ VLP-100

▼ VLP-200

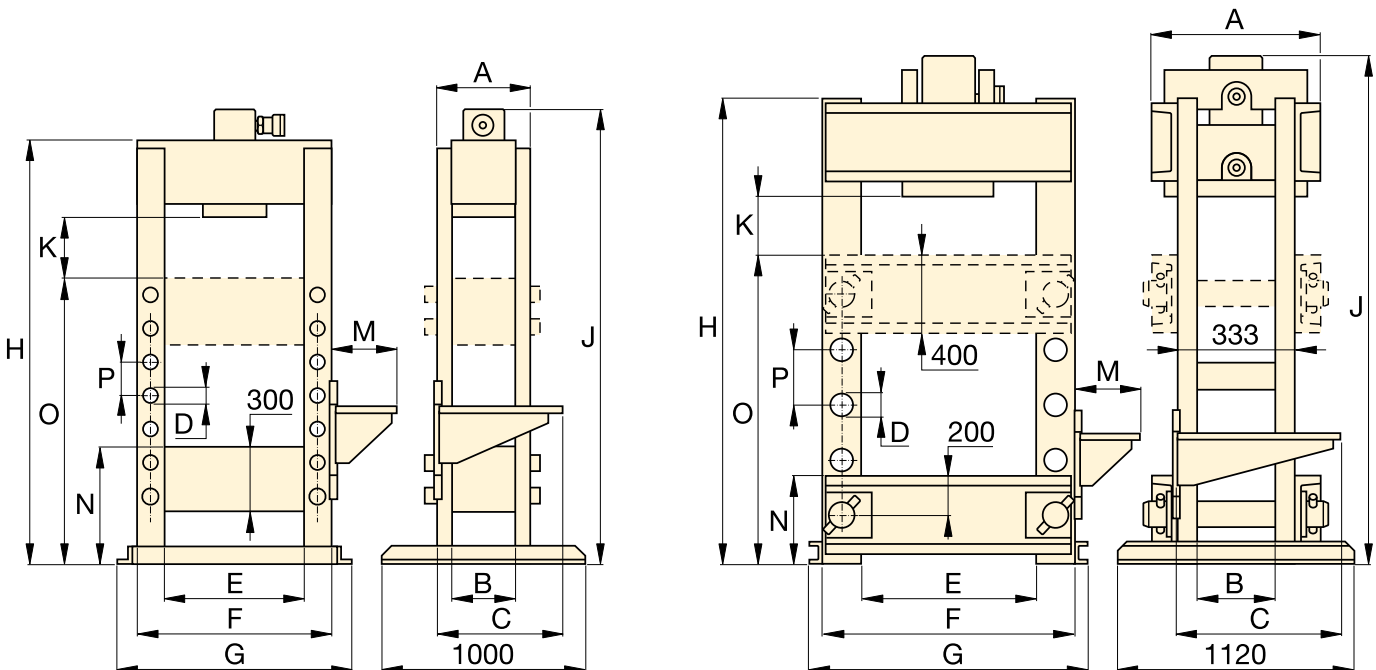



# 100 and 200 tons Hydraulic Workshop Presses

## ▼ PRESS DIMENSIONS CHART (IN MM)

| Press Series        | VLP-100     |              | VLP-200      |
|---------------------|-------------|--------------|--------------|
| Capacity ton (kN)   | 100 (989)   |              | 200 (1995)   |
| Cylinder Stroke     | 168         | 330          | 330          |
| Model Number        | VLP-1006ZES | VLP-10013ZES | VLP-20013ZES |
| Vertical Daylight   | 239 - 989   | 239 - 989    | 377 - 1340   |
| Horizontal Daylight | 990         | 990          | 1220         |
| Bed Width           | 340         | 340          | 553          |
| A                   | 400         | 400          | 553          |
| B                   | 340         | 340          | 233          |
| C                   | 560         | 560          | 560          |
| D                   | 40          | 40           | 76           |
| E                   | 990         | 990          | 1220         |
| F                   | 1240        | 1240         | 1620         |
| G                   | 1400        | 1400         | 1740         |
| H                   | 1879        | 1879         | 2285         |
| J                   | 1885        | 2050         | 2370         |
| K                   | 239         | 239          | 377          |
| M                   | 425         | 425          | 425          |
| N                   | 540         | 540          | 453          |
| O                   | 1290        | 1290         | 1415         |
| P                   | 150         | 150          | 254          |
| Weight (kg)         | 970         | 993          | 1992         |



### V-Blocks\*

To facilitate positioning of pipes and bars, or placed upside-down, to serve as a convenient worktable. Featuring precise fit into the press bolster. Each model number includes two V-blocks.

| To be used with press (ton) | V-Blocks (set) Model Number |
|-----------------------------|-----------------------------|
| 100                         | VB-101                      |
| 200                         | A-200                       |

\* To be ordered separately.

▼ BPR-5075



## BPR-Series Presses



### Cylinder adjustment

Standard roll head design allows horizontal side to side cylinder positioning.



### Hydra-Lift

Allows easy, effortless daylight adjustment of upper bed. Standard on all Roll-Frame presses.

- Side to side cylinder movement
- Heavy objects can easily be loaded on the lower bed with overhead crane; Frame rolls easily on four steel roller bearings
- Hydra-Lift for easy upper bed movement
- Electric pump with low voltage pendant control.

▼ BPR

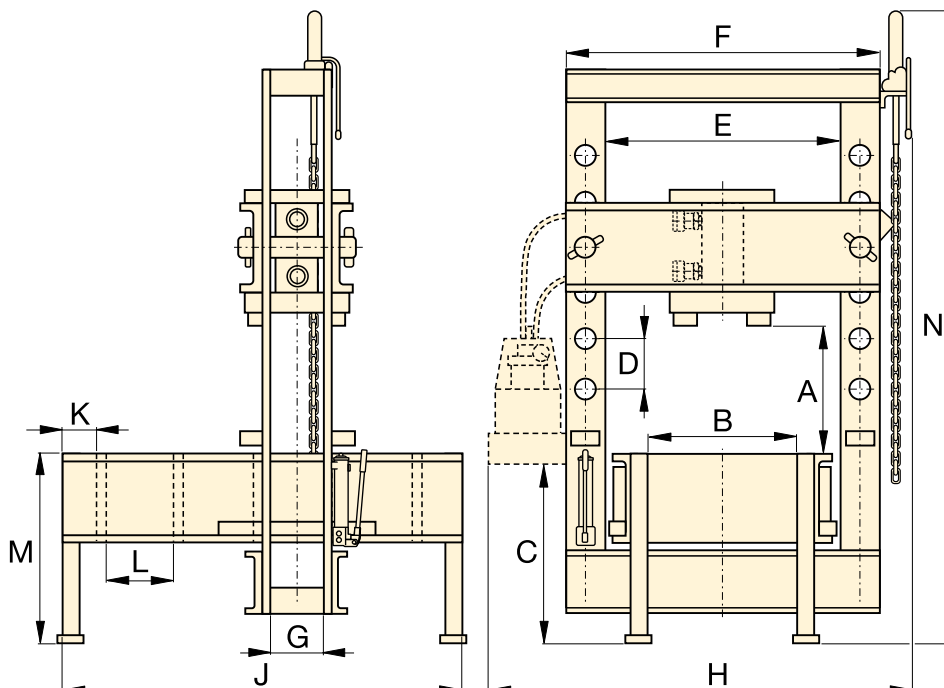

# 50, 100 and 200 tons Roll-Frame Presses

## ▼ ROLL-FRAME PRESS DIMENSIONS CHART (IN MM)

| Model Number         | BPR-5075   | BPR-10075  | BPR-20075  |
|----------------------|------------|------------|------------|
| Capacity ton (kN)    | 50 (498)   | 100 (933)  | 200 (1995) |
| Cylinder Stroke (mm) | 334        | 333        | 330        |
| Electric pump        | ZE5420SW-S | ZE3420SW   | ZE4420SW   |
| Vertical Daylight    | 152        | 159        | 279        |
| Horizontal Daylight  | 942        | 1048       | 1295       |
| Bed Width            | 730        | 889        | 1219       |
| A                    | 152 - 942  | 159 - 1048 | 279 - 1295 |
| B                    | 526        | 673        | 984        |
| C                    | 971        | 965        | 933        |
| D                    | 264        | 222        | 254        |
| E                    | 730        | 889        | 1219       |
| F                    | 933        | 1143       | 1626       |
| G                    | 127        | 146        | 232        |
| H                    | 1420       | 1605       | 2150       |
| J                    | 1626       | 1676       | 2197       |
| K                    | 203        | 203        | 203        |
| L                    | 270        | 270        | 381        |
| M                    | 762        | 813        | 915        |
| N                    | 2870       | 3021       | 3200       |
| Weight (kg)          | 917        | 1767       | 4168       |



### Gauges

All press models include a pressure/force gauge and gauge adaptor, matching the press capacity:

| Press Capacity (ton) | Gauge Model Number | Adaptor Model Number |
|----------------------|--------------------|----------------------|
| 50                   | GF-50B             | GA-2                 |
| 100                  | GF-871B            | GA-3                 |
| 200                  | GF-200B            | GA-3                 |

▼ SAFETY CAGE FOR XLP25, 50 AND 75 SERIES



## Safety First



**Options**  
Door safety switch and/or  
2-hand operation

Page: **15**



### IMPORTANT!

Only available for factory  
assembled press frames (see note  
page 6).

For other press sizes contact  
customer support.

- Safety cage made of aluminium frame and polycarbonate glass for additional operator protection
- Front and (optional) rear door for easy access to press bed



▼ XLP-SERIES, DOOR TYPE (FRONT AND/OR REAR DOOR)



# Press Safety Options

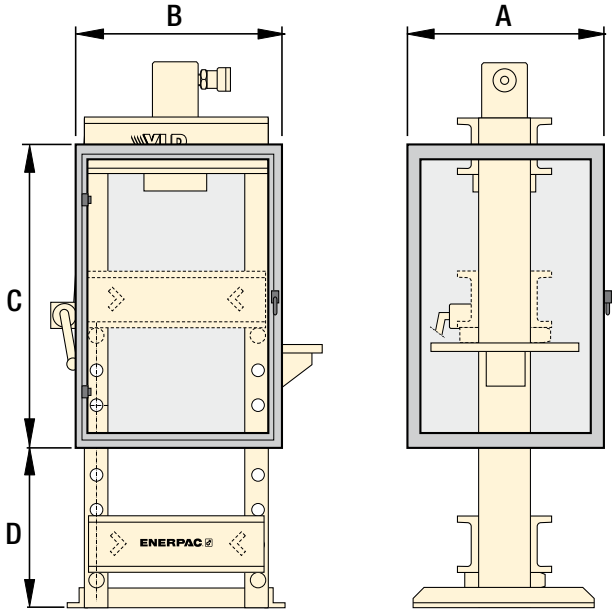

**XLP 25 ton**

| Press Series    | XLP25    | XLP50    | XLP75    |
|-----------------|----------|----------|----------|
| Model Number    |          |          |          |
| Front door      | XLP25SC1 | XLP50SC1 | XLP75SC1 |
| F and R door    | XLP25SC2 | XLP50SC2 | XLP75SC2 |
| Dimensions (mm) |          |          |          |
| A               | 560      | 700      | 700      |
| B               | 690      | 1250     | 1300     |
| C               | 1000     | 1000     | 1000     |
| D               | 460      | 540      | 540      |

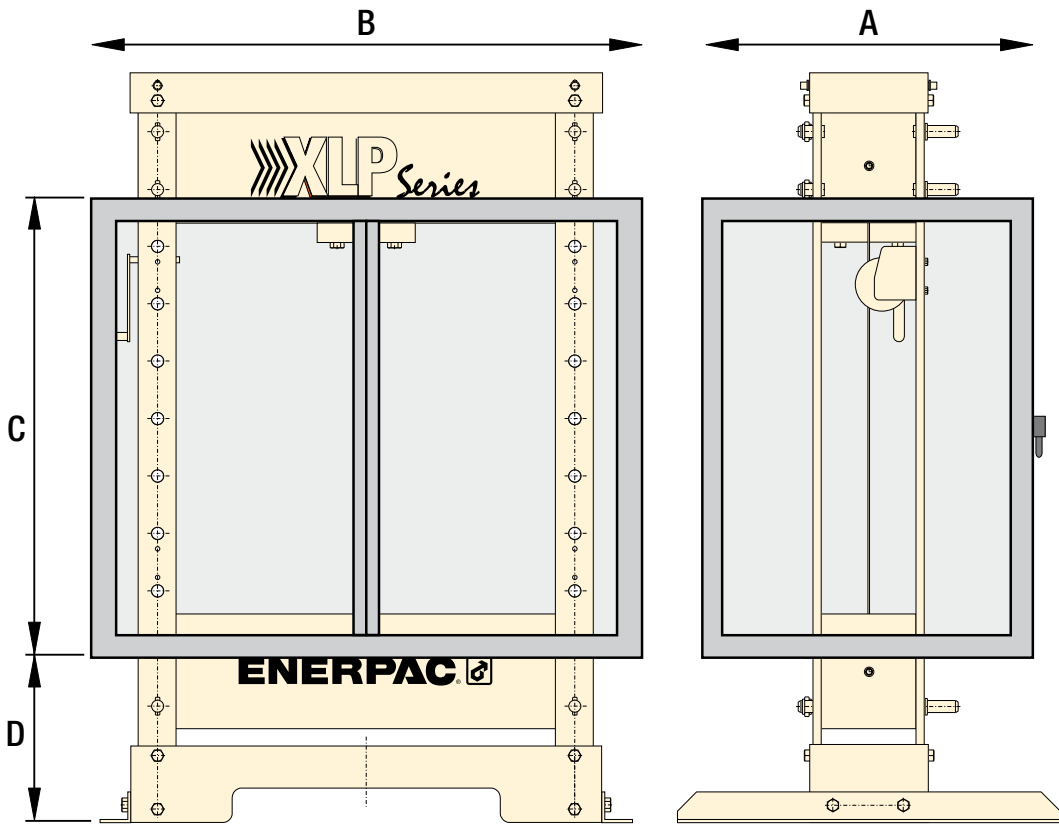

**XLP 50 - 75 ton**

▼ SAFETY SCREEN TO BE FREELY POSITIONED BEFORE ANY PRESS



## Universal Safety Screen

Order Model number: **XLP-SS1**

- Safety screen allows for versatile use and protection during press operation
- Lockable casters for easy positioning

▼ DIMENSIONS

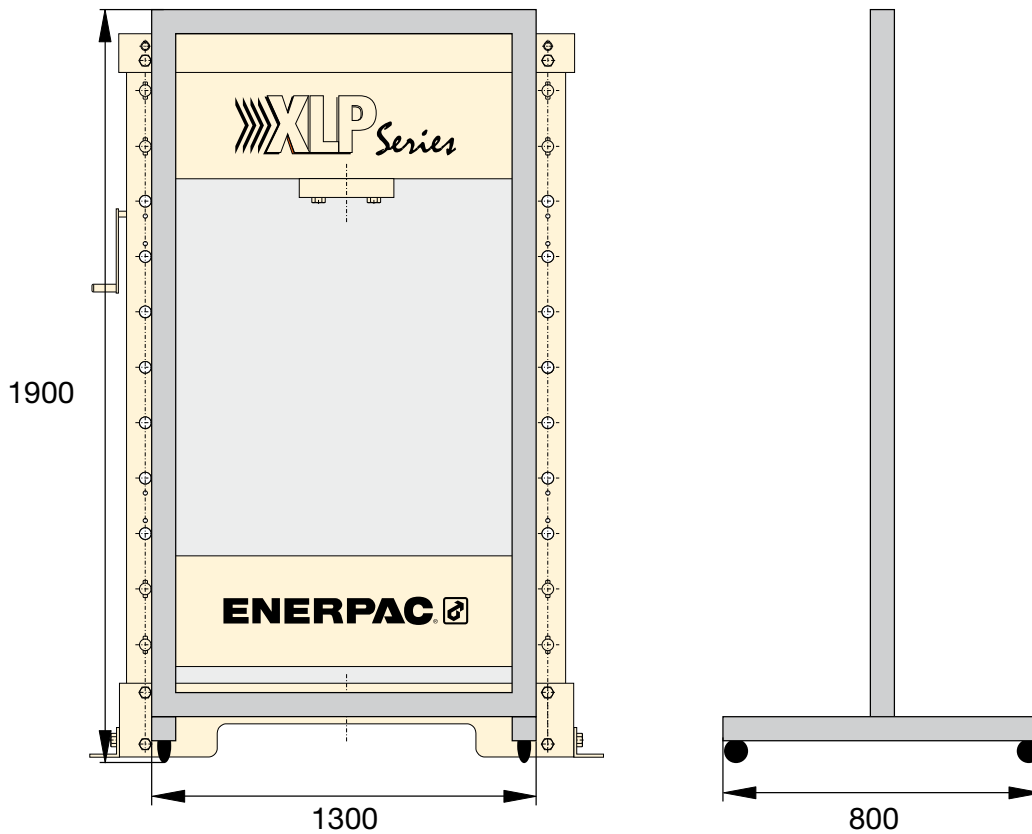





## Gauges

Where hydraulic cylinders in presses generate high forces, it is very important to know how much; an inline mounted hydraulic gauge is “a window into your system”. Enerpac has a wide range of hydraulic gauges with pressure and/or force indication



## Hydraulic Pumps

To drive hydraulic presses, Enerpac offers a large variety of hand, air or electric operated pumps; depending on customer’s needs for speed and force, we provide pumps with a wide range of flow and pressure



## Two Hand Operation

In combination with electric pumps Enerpac can offer Two Hand control units for additional operator safety



## Door Safety Switch

In combination with electric pumps Enerpac can offer door switches for safety cages; this will prevent operation of the press while the safety door is open.



## XA-Series Foot Pump

The XLP-press with XA-Series air powered foot pump: no need to fully lift up foot – rest bodyweight on heel, resulting in a handsfree and stable working position.

## Custom made presses

Next to our large range of standard workshop presses, Enerpac offers the possibility of customization.

Because many customers have specific requirements, we offer turn-key project management, including design, engineering and manufacturing. As market leader we listen to our customers and with our world wide experience offer the best solutions, especially when safety is not negotiable.

Below you find a selection of press customization projects. Ranging from small 10 ton C-frame presses for bearing replacement, to 1000 ton press frames to test valves for the oil and gas industry.

In case you have the need for a custom made press, be sure to contact Enerpac first.



## PLC-Controlled 1800 Ton High- Accuracy Press

### Fully Automated PLC-Controlled 1800 Ton High-Accuracy Press

The pressing and heating cycle, during the production of magnetic acceleration coils, required high force and high- accuracy to ensure absolute quality.

Enerpac was consulted to assist in the design of a high accuracy production press. Control of the press force is monitored along with the temperature of the coils during forming by a PLC Control System.



## Horizontal 250 Ton Press for Train Maintenance

### Horizontal Press for Train Maintenance

This Enerpac horizontal press gives easy access for loading and unloading. The daylight can be adjusted by moving the bed over the full press length, while the opening in the adaptor plate in this moveable bed can be adjusted for various axle diameters.

The double-acting cylinder gives the full advantage of controlling both push and pull forces.



## 600 Ton High-Accuracy Collar Press

### High-Accuracy Collar Press

For production of accelerator coils, sheet metal needs to be formed into a specific shape and size. The end product of this forming is a cylindrical collar, which has a very solid structure, specific shape, and a tight tolerance for circularity and concentricity.

The 600-ton press consisted of two separate hydraulic systems. The first system featured eight 25-ton cylinders, to position the sheets, while the second system featured eight 75-ton cylinders, to press the sheets into the correct shape.



## 50 Ton Workshop Press for Maintenance Jobs

### Workshop Press for Maintenance Jobs

This C-shaped workshop press was designed giving access for workpiece loading from three sides while the fixed worktable features T-slots to mount tooling. Pressure and force can be checked with the gauge in the upper bed. Activation of hydraulics can only be done using both hands to press the safety control device.

Another Enerpac user, satisfied by safe and long, trouble-free usage of our hydraulic system design.



## 50 Ton Workshop Press for High-Cycle Punching

### Workshop Press for High-Cycle Punching

This Enerpac press is designed for the various punching applications, while the T-slotted worktable and threaded plunger allow quick change of tooling. Plunger bearing and guidance ensure the punching of steel plates within narrow tolerances. The two hand control system prevents accidental activation of hydraulics.

Fast punching within close tolerances is achieved. Another example of how Enerpac system design provides safe, cost and laborsaving solutions.





## 200 Ton Deep Draw Press with 2 Hand Operation

**Deep Draw Press with 2 Hand Operation**

For a manufacturer in the white appliance industry we custom build a 200 ton deep draw press with high flow pump, metal safety gate and 2-hand operation pult



## 200 Ton Roll Frame Press

**200 ton Roll Frame Press**

For a large manufacturing plant in the chemical industry this 200 ton Roll-Frame Press has been equipped with a vertical sliding safety cage. The press is used for maintenance jobs like replacing motor and shaft bearings.



## 550 Ton Manufacturing Press

### 550 ton Manufacturing Press

For a world leading manufacturer in the automotive industry, we build a custom made press to assemble drive train components.

This semi-automated 550 ton press, has a daylight opening of 620 mm and cylinder stroke of 160 mm.

Front and rear side feeding tables allow for easy loading of parts with a max. width of 500 mm.

Steel sliding doors provide maximum safety to this manufacturing press.



## 50 Ton Press for Welders Qualification Test

### 50 Ton Press for Welders Qualification Test

As part of welders qualification test, welding samples are positioned in the press. Force is applied until the weld seam is destroyed. The applied pressure/force is an indication whether the weld was strong enough. An aluminium cage with polycarbonate glass provided additional safety to the operator while witnessing the test.





## 1000 Ton Press Frame for Testing of Hydraulic Cylinders

### 1000 Ton Press Frame for Testing of Hydraulic Cylinders

For repair, assembly and testing of high tonnage cylinders Enerpac service centers make use of a static press frame; daylight dimensions 900 x 600 mm



## 100 Ton Press for Assembly of Spring Loaded cylinders

### Press for Assembly of Spring Loaded Cylinders

For offshore application high capacity spring loaded cylinders need to be assembled and tested. A special 100 ton roll frame press, with long stroke cylinder has been constructed.

All movements are operated and monitored through a PLC controlled pendant.



## Heavy Spring Assembling for Suspension of Rail Wagons

### High-Accuracy Collar Press

Special C-Press with hydraulic cylinders mounted vertically and horizontally onto the press to press heavy duty springs into position.



## Certified Security Press for Testing of Train Wheelset Joints

### Fully Automated PLC-Controlled 1800 Ton High-Accuracy Press

Enerpac special press system for pressing wheels on axles and testing the security press-fit of the wheelset joints. A perfect marriage between hydraulics and electronics providing a certified and easy to control process.



### 200 Ton Press with Steel Safety Cage

**200 Ton Press with Steel Safety Cage**  
Press with front table for easy loading and positioning of parts. Safety cage with door switches and remote operation stand.



### Custom Made 200 Ton Press to Refurbish Gear Boxes

**Custom Made 200 Ton Press to Refurbish Gear Boxes**  
For the overhaul department of a global leader in mining and construction machines a special roll frame press was manufactured:

- Side shift of press cylinder
- extra wide and extra high press frame
- electric height adjustment of upper bed
- horizontal electric transition of press frame
- vertical electric sliding protection cage
- hydraulic clamp to hold workpiece on lower bed





# Hydraulic Presses



## The Industrial Tools Line

### Cylinders and Lifting Products

- General Purpose
- Aluminium Lightweight
- Pancake
- Flat-Jac®, Low Height
- Pull
- Hollow Plunger
- Precision
- Long Stroke
- High Tonnage
- POWR'RISER® Lifting Jacks
- Jacks
- Cylinder-Pump Sets

### Pumps

- Manual
- Cordless & Electric Driven
- Compressed Air Driven
- Petrol Driven

### System Components

- Hoses, Couplers, Oil
- Gauges, Adaptors
- Manifolds, Fittings

### Valves

- 3-and 4-Way Directional
- Pressure and Flow Control

### Presses

- Bench, Workshop, Roll Frame
- Arbor and C-Clamps
- Tension Meters, Load Cells

### Pullers

- Master Pullers Sets
- Multi Purpose Puller Sets
- Posi Lock® Pullers

### Tools

- Maintenance Sets
- Punches
- Machine Lifts
- Lifting Wedge
- Load Skates
- Cutters
- Pipe Benders
- Wedgie, Spreaders

### Bolting Tools

- Multipliers
- Torque Wrenches
- Impact Sockets
- Bolt Tensioners
- Wrench and Tensioner Pumps
- Flange Alignment Tools
- Flange Facing Tool
- Nut Splitters

### Integrated Solutions

- Synchronized Lifting Systems
- Jack-Up Systems
- Bridge Launching Systems
- Synchronized Hoisting Systems
- Hydraulic Gantries
- Heavy Lifting Strand Jacks Systems
- Skidding Systems
- Self-Erecting Towers
- Self Propelled Modular Transporter
- Chain Pulling Systems

## Enerpac Worldwide Locations

For a complete list of addresses see:  
[www.enerpac.com/en/enerpac-locations](http://www.enerpac.com/en/enerpac-locations)

## About Enerpac

Enerpac is the leading global provider of high-pressure hydraulic tools and solutions with a broad range of products, local expertise and worldwide distribution network. With a proven track record in a wide range of markets, Enerpac designs and manufactures high-quality tools and solutions for all industrial applications.

Enerpac has gained unique experience in delivering hydraulic solutions for the controlled movement and positioning of heavy objects. Enerpac supports your business by offering the right solutions and service to help you get your work done efficiently and safely.



## www.enerpac.com for latest Enerpac information

- New products
- Trade shows
- Manuals (instruction and repair sheets)
- Nearest Distributors and Service Centers
- Enerpac products in action.



## Enerpac catalogues and brochures to meet your needs

To obtain your copy just give us a call, or visit [enerpac.com](http://enerpac.com)



## Enerpac Bolting Vans

- Demonstrate Enerpac Bolting Tools on your premises
- Calibrate all Bolting Tool brands
- Training for the safe and efficient use of Bolting Tools.



## Enerpac Academy

Enerpac Academy is our in-house training center, set up exclusively for Enerpac business partners, Enerpac users and Enerpac employees: training programs ranging from tool expertise, repairs and maintenance, to safe operation of high-pressure hydraulic tools.

Your Enerpac Distributor: